



PCB-651

DATE OF THE BULLETIN:

December 31st, 2019

THIS BULLETIN SPERSEDED BULLETIN(S):

None

MODELS AFFECTED:

Models equipped with Cylindrical decks

MACHINE SYMPTOMS:

None

SCOPE OF BULLETIN:

Cylindrical decks now have an aluminum motor spacer plate

MATERIALS REQUIRED:

None

REVISIONS:

To speed up repairs, we have replaced the offset washers with a solid aluminum spacer plate that separate the Motor Height Adjustment Bracket and the Deck Wall.

If you wish to replace washers with new aluminum spacer plate, order **Part #: 650-9004**.

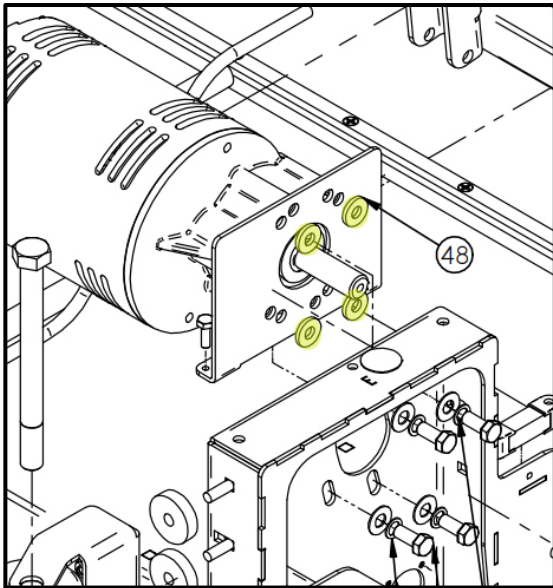

(Old Washers in **YELLOW**)

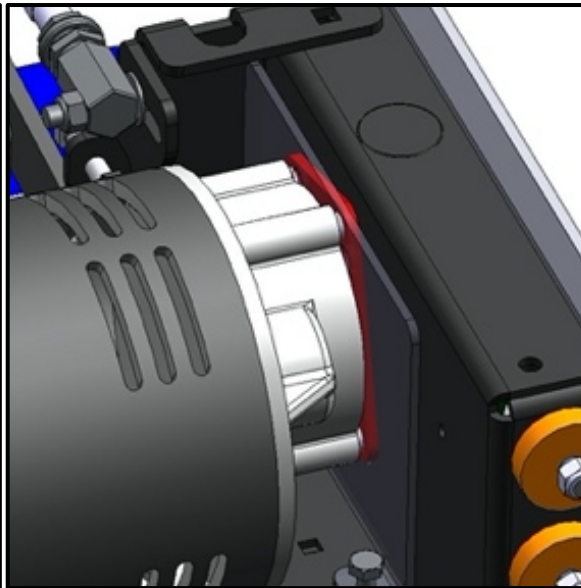

(New Spacer Plate in **RED**)